

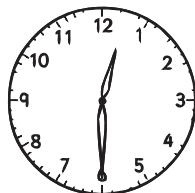

# L/LT & BT Series Sampling Instructions

## Sample Preparation

1. Run equipment for approximately 30 minutes to get the oil hot.



2. Exercise extreme caution in the vicinity of operating equipment. Use gloves and eye protection. Skin contact or inhalation can cause irritations.



3. Record all data & Identification on forms & attach labels to bottle



4. Pull the tubing out of the bag, keeping the zip seal partially closed. Remaining tubing should remain in a coil for next use.



## Standard Sample Method

5. Insert tube ends into the probe barb & the vacuum pump & bottle. Tighten knob snug.

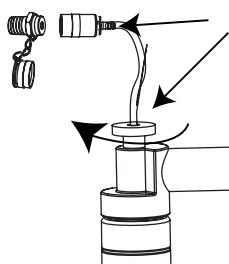

6. Thread probe to valve. Pull back on the handle to draw the purge sample. Purge volumes vary according to length and diameters.

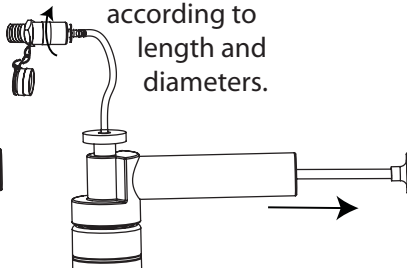

7. Unthread the probe, 2 turns only. This will close the valve. Remove purge bottle and thread on the sample bottle.

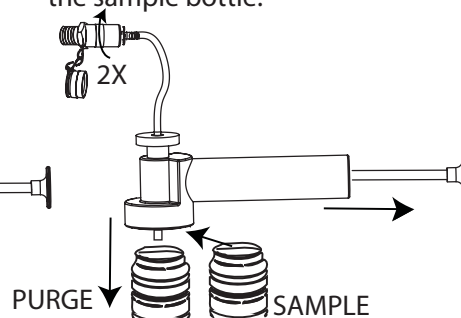

## Sealed Sample Method

1. To avoid air borne contamination, remove cap inside a sealed zip bag and create a drum like membrane.

2. Thread the bottle onto the vacuum pump and sample.

3. After sampling replace the cap inside the bag before removing.

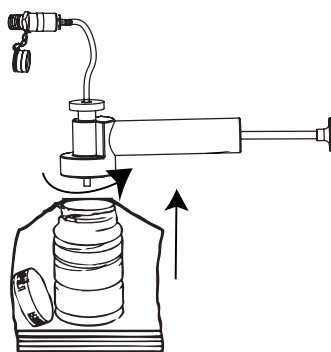

## Sample Completion

8. Dispose of the plastic tubing, bags and purge oil responsibly.

9. Send the bottle as soon as possible to the appropriate lab for analysis.



sales@checkfluid.com  
www.checkfluid.com

Checkfluid Inc.  
Toll Free: 866-652-8728  
Fax: 519-652-0392